

WEST SUSSEX COUNTY COUNCIL
((HORSHAM DISTRICT) (PARKING PLACES AND TRAFFIC REGULATION)
(CONSOLIDATION NO. 2) ORDER 2006)
(CRIPPLEGATE LANE AMENDMENT) ORDER 2017

SOUTHWATER: LOCATION OF WAITING RESTRICTIONS

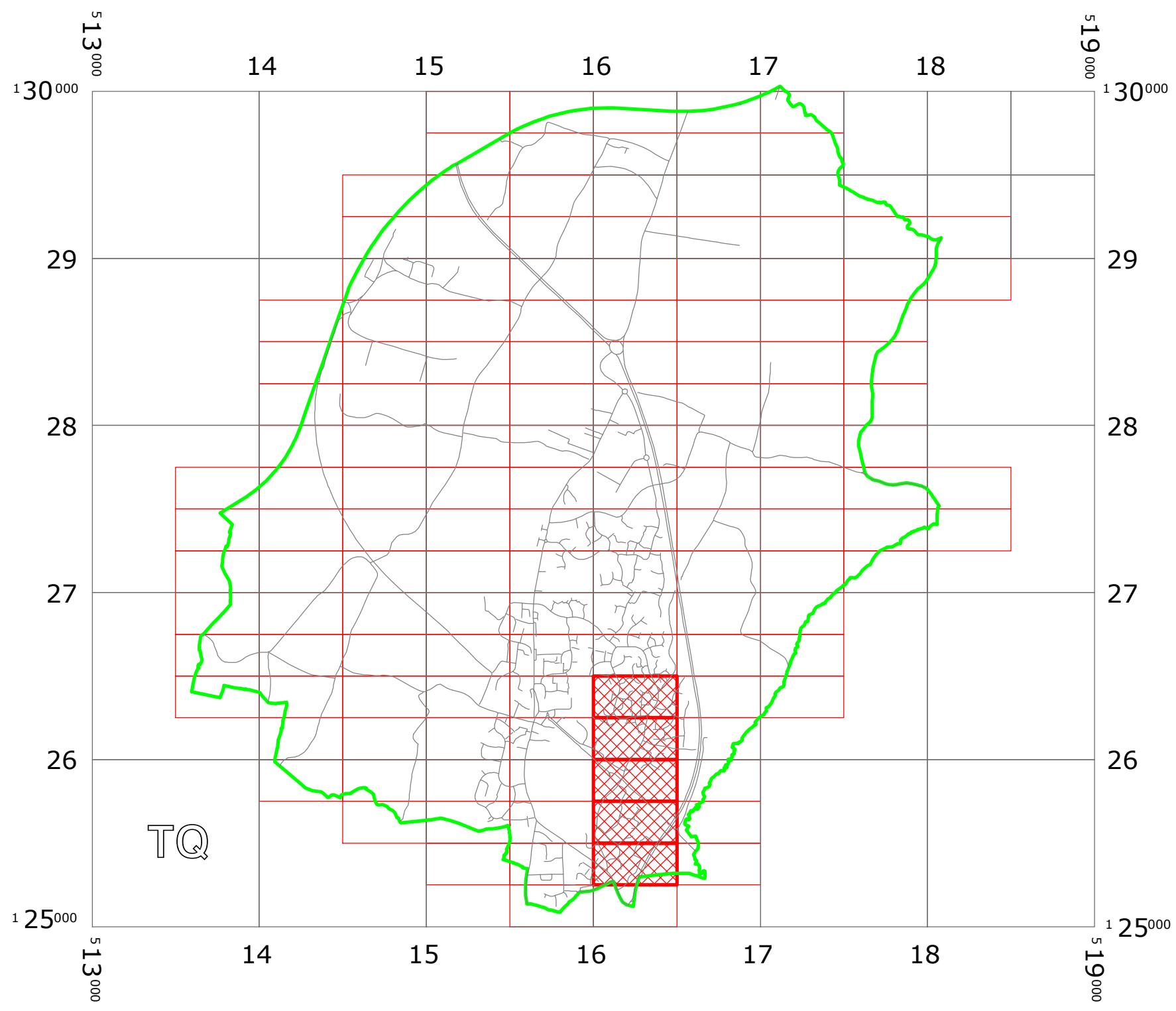

KEY:

OS.TILE GRID

PARKING TILE GRID

LOCATION OF WAITING RESTRICTIONS

PARISH BOUNDARY

ROAD NETWORK



West Sussex County Council
Highways & Transport
The Grange
Tower Street
Chichester
West Sussex
PO19 1RH

WEST SUSSEX COUNTY COUNCIL
(HORSHAM DISTRICT)
(PARKING PLACES AND TRAFFIC REGULATION)
(CONSOLIDATION NO. 2) ORDER 2006)
(CRIPPLEGATE LANE AMENDMENT) ORDER 2017

LOCATION OF WAITING RESTRICTIONS



Key for Waiting Restrictions

All areas over which the provision of the orders apply are defined by the shaded areas as shown on the following plans plus a contiguous area not indicated on the plans of verge and/or footway between the carriageway edge and the highway boundary. The plans in this schedule are based upon grid references of the Ordnance Survey National Grid defined by the OSGB 36 triangulation.

Prohibition of waiting at any time

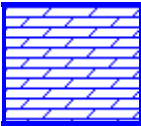
101		check	No waiting at any time
143		usgs642	No waiting 9.00am-5.00pm any day 01Apr-31Oct

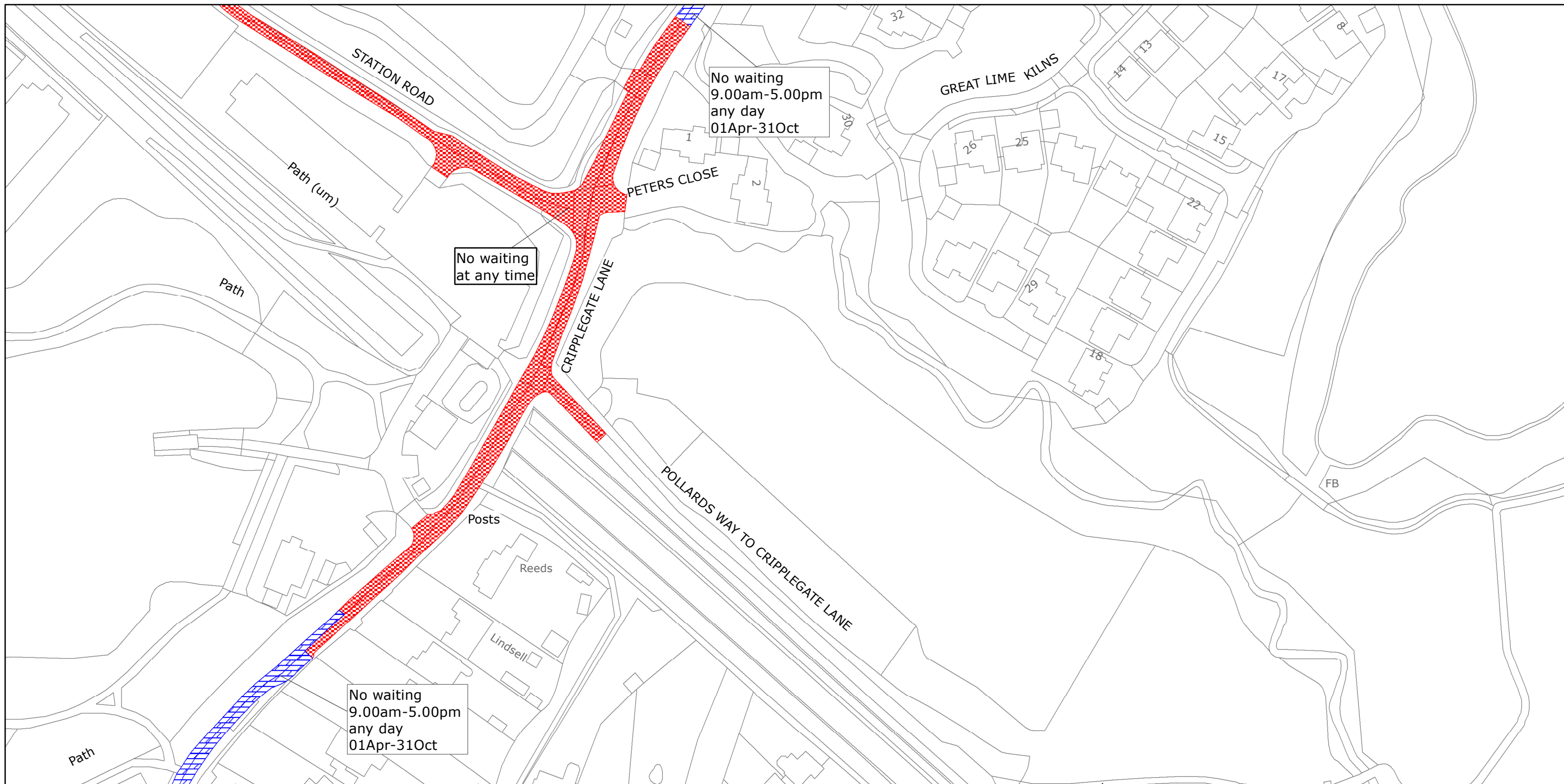

West Sussex County Council
Highways & Transport
The Grange
Tower Street
Chichester
West Sussex
PO19 1RH

HORSHAM DISTRICT: SOUTHWATER
WAITING RESTRICTIONS

Reproduced from or based upon 2017 Ordnance Survey mapping with permission of the Controller of HMSO (c) Crown Copyright reserved.
Unauthorised reproduction infringes Crown copyright and may lead to prosecution or civil proceedings West Sussex County Council Licence No. 100018485

TILE REF NO:
TQ1625NWN

SHEET ISSUE NO 2
SHEET ACTIVE FROM - 10/07/2017



SCALE:
1:1250
at A3 size



West Sussex County Council
Highways & Transport
The Grange
Tower Street
Chichester
West Sussex
PO19 1RH

HORSHAM DISTRICT: SOUTHWATER
WAITING RESTRICTIONS

Reproduced from or based upon 2017 Ordnance Survey mapping with permission of the Controller of HMSO (c) Crown Copyright reserved.
Unauthorised reproduction infringes Crown copyright and may lead to prosecution or civil proceedings West Sussex County Council Licence No. 100018485

TILE REF NO:
TQ1625NWS

SHEET ISSUE NO 1
SHEET ACTIVE FROM - 10/07/2017



SCALE:
1:1250
at A3 size

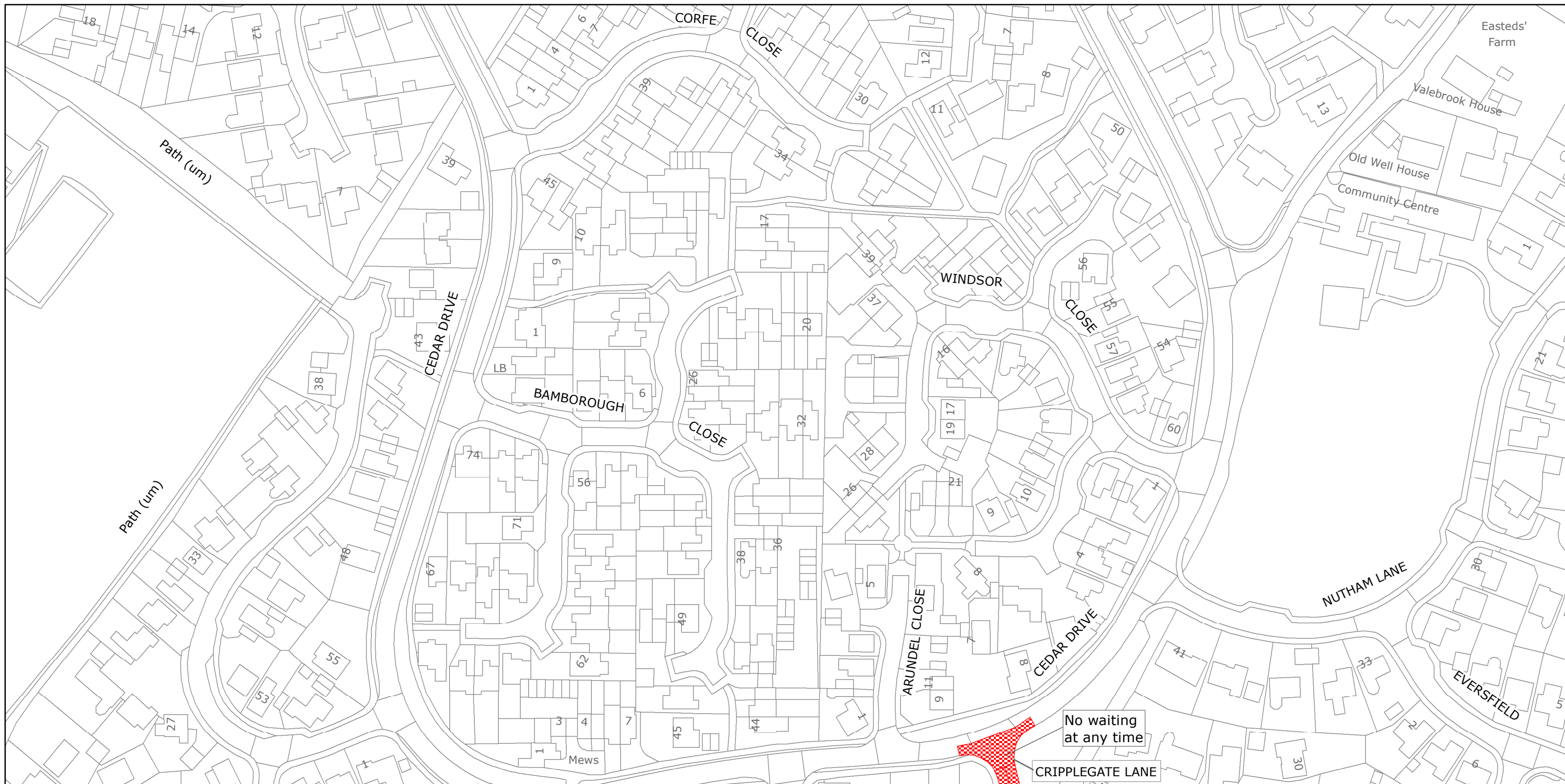

West Sussex County Council
Highways & Transport
The Grange
Tower Street
Chichester
West Sussex
PO19 1RH

HORSHAM DISTRICT: SOUTHWATER

WAITING RESTRICTIONS

Reproduced from or based upon 2017 Ordnance Survey mapping with permission of the Controller of HMSO (c) Crown Copyright reserved.
Unauthorised reproduction infringes Crown copyright and may lead to prosecution or civil proceedings West Sussex County Council Licence No. 100018485

TILE REF NO: TQ1626SWN

SHEET ISSUE NO 1
SHEET ACTIVE FROM - 10/07/2017



SCALE:
1:1250
at A3 size

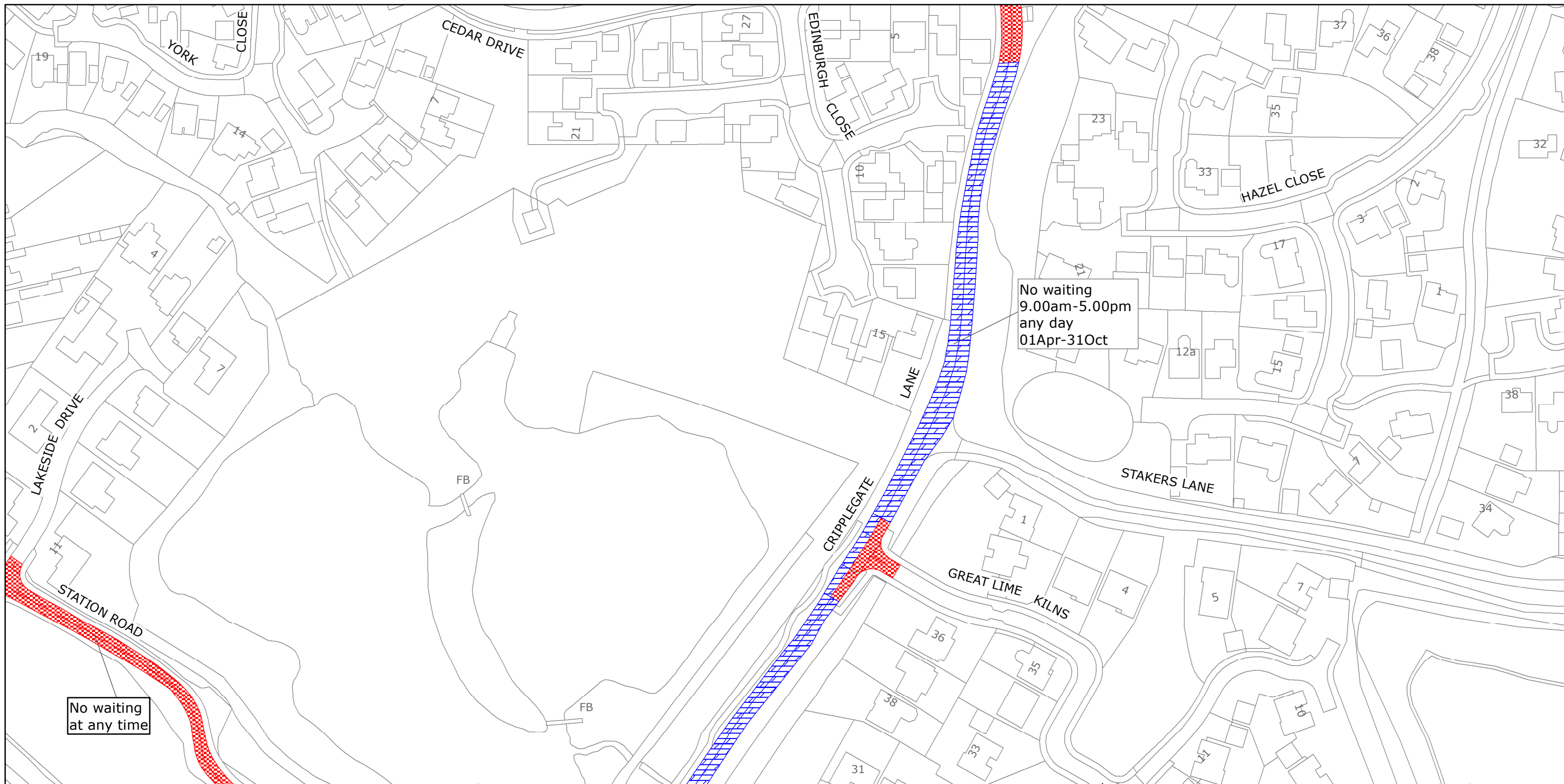

West Sussex County Council
Highways & Transport
The Grange
Tower Street
Chichester
West Sussex
PO19 1RH

HORSHAM DISTRICT: SOUTHWATER
WAITING RESTRICTIONS

Reproduced from or based upon 2017 Ordnance Survey mapping with permission of the Controller of HMSO (c) Crown Copyright reserved.
Unauthorised reproduction infringes Crown copyright and may lead to prosecution or civil proceedings West Sussex County Council Licence No. 100018485

TILE REF NO:
TQ1626SWS

SHEET ISSUE NO 2
SHEET ACTIVE FROM - 10/07/2017



SCALE:
1:1250
at A3 size